

USB	
1	GND
2	D+
3	D-
4	VDD
5	NC
6	NC

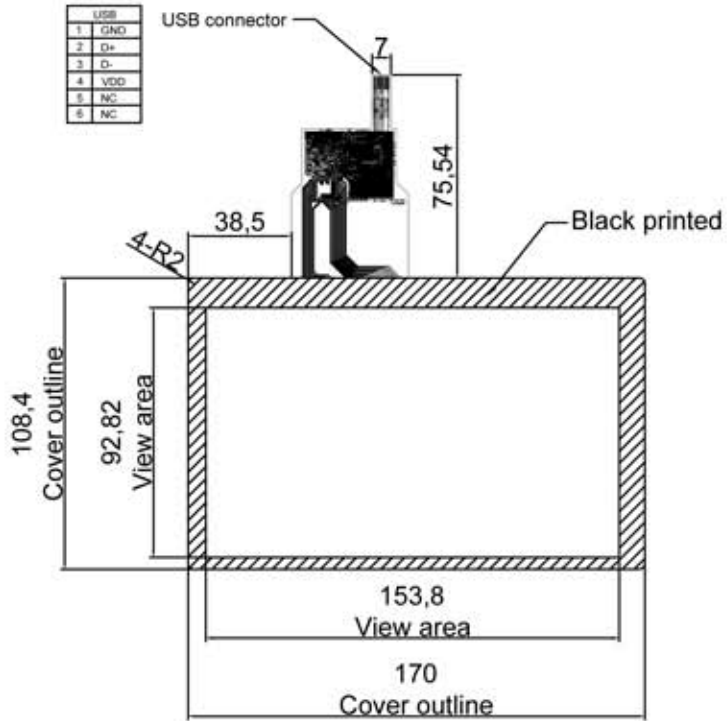

FRONT SIDE VIEW

Sensor thickness 0,51  
 Cover glass thickness 1,1  
 Touch panel thickness 1,61

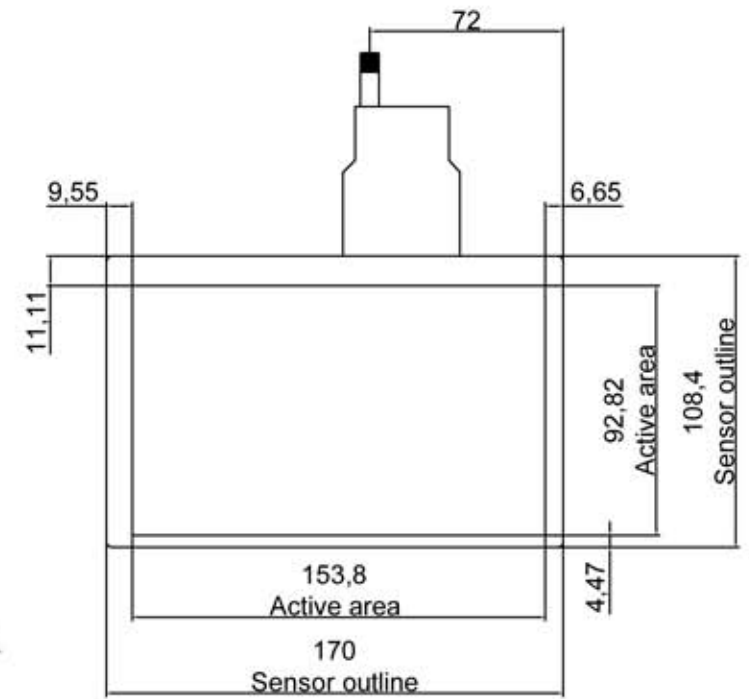

BACK SIDE VIEW

- TOUCH PANEL THICKNESS : 1.61mm±10%  
COVER GLASS THICKNESS : 1.1mm±10%  
SENSOR THICKNESS : 0.51mm±10%
- TRANSPARENCY : 85% OR MORE
- TAIL : COF STYLE (COPPER TRACE)

No.	m/d/y	Rev.	Description
8			
7			
6			
5			
4			
3			
2			
1	04/25/12	001	First Release

		DESIG'D	T.H.KIM	
		CHK'D	S.K.JUNG	
DATE		2012.04.25	DWG NO.	DP070-08-001
SIZE	REF NO.	PDT NO.	CVS-PC-070-003-120425	
A4	NULL		SCALE	NULL
UNIT		MM[INCH]	UNDEFINED TOL.	±0.3
			SHEET NO.	1/1

APPROVED BY